

**EIGHTH ANNUAL
GREAT AMERICAN MOCK TRIAL INVITATIONAL**

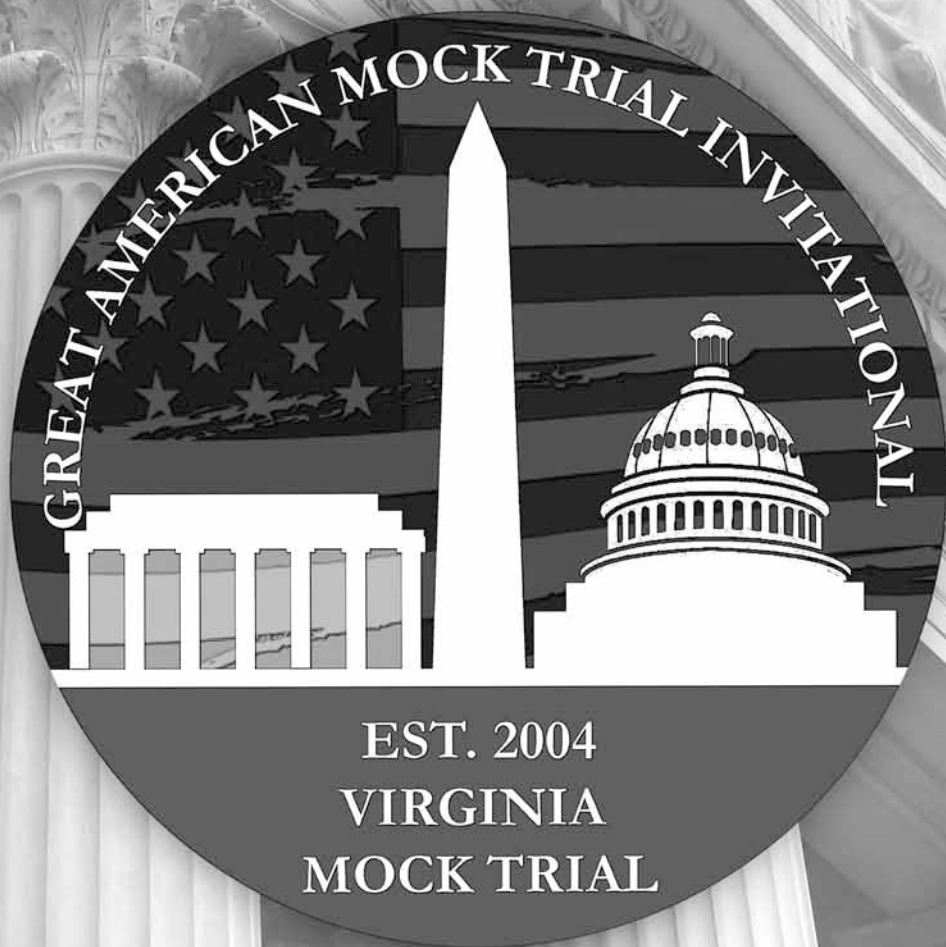

NOVEMBER 5-6, 2011, WASHINGTON, DC

TABLE OF CONTENTS

SCHEDULE AND LOCATIONS.....3

SPONSORS.....4

CHALLENGE ORDER.....5

INTERNAL MAP OF PRETTYMAN COURTHOUSE.....6

MAP OF COURTHOUSE LOCATIONS AND SURROUNDING AREA.....7

RULES FOR USE OF THE COURTHOUSES.....8



QUESTIONS?

Please contact Sarah Sawtelle at (202) 255-7748 or sarahsawtelle@gmail.com or Toby Heytens at (202) 257-2635 or tobyheyten@gmail.com.

SCHEDULE AND LOCATIONS

SATURDAY, NOVEMBER 5

H. CARL MOULTRIE COURTHOUSE, 500 INDIANA AVE. NW



- 8:30 a.m.** TEAM REGISTRATION
(Inside Indiana Ave. entrance)
- 9 a.m.** OPENING CEREMONIES
(Jurors' Lounge, Third floor)
- 9:45 a.m.** ROUND 1 CAPTAINS' MEETING
(Location TBA)
- 10:15 a.m.** ROUND 1
- 1 p.m.** LUNCH
(On your own)
- 2:30 p.m.** ROUND 2 CAPTAINS' MEETING
(Location TBA)
- 3 p.m.** ROUND 2

SUNDAY, NOVEMBER 6

E. BARRETT PRETTYMAN COURTHOUSE, 333 CONSTITUTION AVE. NW
ENTRANCE ON 3RD ST. BETWEEN CONSTITUTION AVE. AND C ST.



- 9:15 a.m.** ROUND 3 CAPTAINS' MEETING
(Courtroom 20, Sixth floor)
- 9:45 a.m.** ROUND 3
- 12:30 p.m.** LUNCH
(First floor cafeteria will be open)
- 2 p.m.** ROUND 4 CAPTAINS' MEETING
(Courtroom 20)
- 2:30 p.m.** ROUND 4
- 5 p.m.** RECEPTION
(First floor cafeteria)
- ASAP** CLOSING CEREMONIES
(Courtroom 20)

Prettyman Tab Room is in the first floor media room (Room 1206)

SPONSORS



haynesboone
Setting precedent.



THANK YOU

Mostafa Abdelkerim, Lu Alvarez, Doug and Mary Chapin, Jake Chervinsky, Warren Craghead, Meredith Davis, Duane Delaney, Lois Epps, Tobias Everke and Barbette Havriliak, Alex Havriliak, Kevin Homiak, Dean Paul Mahoney, Laura Monroe, Ellen Walker, Lisa O'Donnell, Pamela Reeves and Charles Swanson, Carol Richards, The Honorable Lee F. Satterfield, Wanda Starke, Paul Wiley

ADD LEXIS



CHALLENGE ORDER

The challenged team will pick its side, but the Virginia teams will defer their selection to the results of a coin toss. You are not allowed to "pass."

1. **NYU** (564)
2. **Harvard** (796)
3. **Georgia** (826)
4. **Penn** (672)
5. **Brown** (956)
6. **Northwood** (928)
7. **Loyola-Chicago** (494)
8. **Macalester** (576)
9. **Georgetown** (920)
10. **Cincinnati** (644)
11. **Columbia** (514)
12. **Howard** (684)
13. **Michigan** (524)
14. **Maryland** (668)
15. **Washington** (206)
16. **Northwestern** (392)
17. **Duke** (304)
18. **Washington & Lee** (322)
19. **Yale** (928)
20. **GW** (756)
21. **Swarthmore** (650)
22. **UC Santa Cruz** (710)
23. **Virginia A** (972)
24. **Virginia B** (973)



THE PRETTYMAN COURTHOUSE

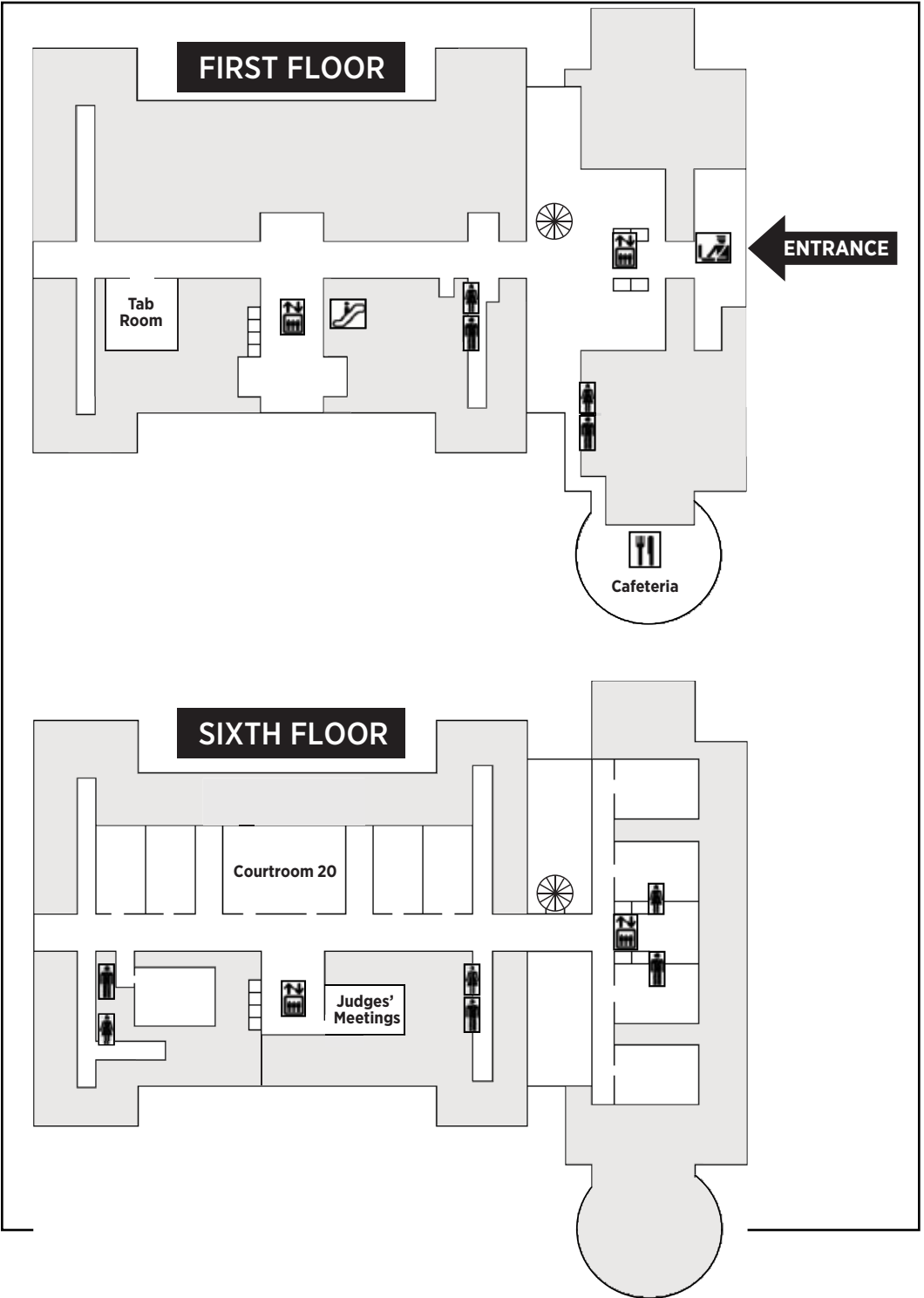

COURTHOUSE LOCATIONS & SURROUNDING AREA

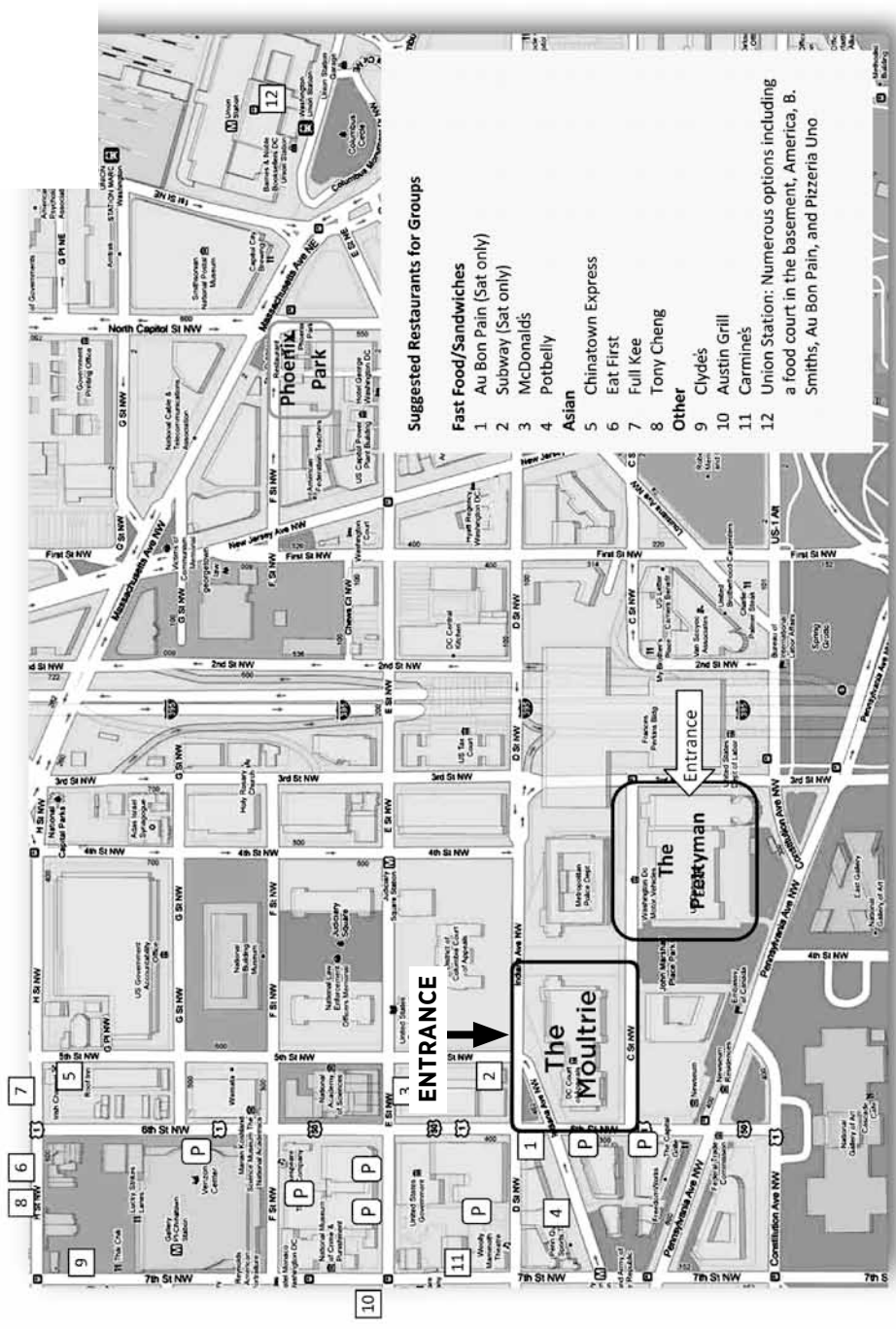

Suggested Restaurants for Groups

Fast Food/Sandwiches

- 1 Au Bon Pain (Sat only)
- 2 Subway (Sat only)
- 3 McDonald's
- 4 Potbelly

Asian

- 5 Chinatown Express
- 6 Eat First
- 7 Full Kee
- 8 Tony Cheng

Other

- 9 Clyde's
- 10 Austin Grill
- 11 Carmine's
- 12 Union Station: Numerous options including a food court in the basement, America, B. Smiths, Au Bon Pain, and Pizzeria Uno

IMPORTANT!

Rules for Use of All Courtrooms

These rules apply to everyone—
competitors, spectators and judges.
No exceptions.

No beverages other than water.
No coffee. No sodas. No exceptions.

No eating. Of anything. No exceptions.

No furniture — including podiums —
may be moved except the chairs
at counsel table and the bench.
No (other) exceptions.

No touching any microphones,
computers or switches.
No exceptions.

